

PIER 62/63

EXISTING CONDITION

Seattle
Aquarium



PIER 62/63



ALASKAN WAY

Waterfront Landing
Condominiums



PIER 62/63

UPDATED SITE PLAN

LEGEND

- ① REBUILT PIER 62
- ② INSTALL NEW RAILING
- ③ INSTALL FLOATING BOAT DOCK
- ④ PROVIDE 30% LIGHT PENETRATION NEAR SHORE

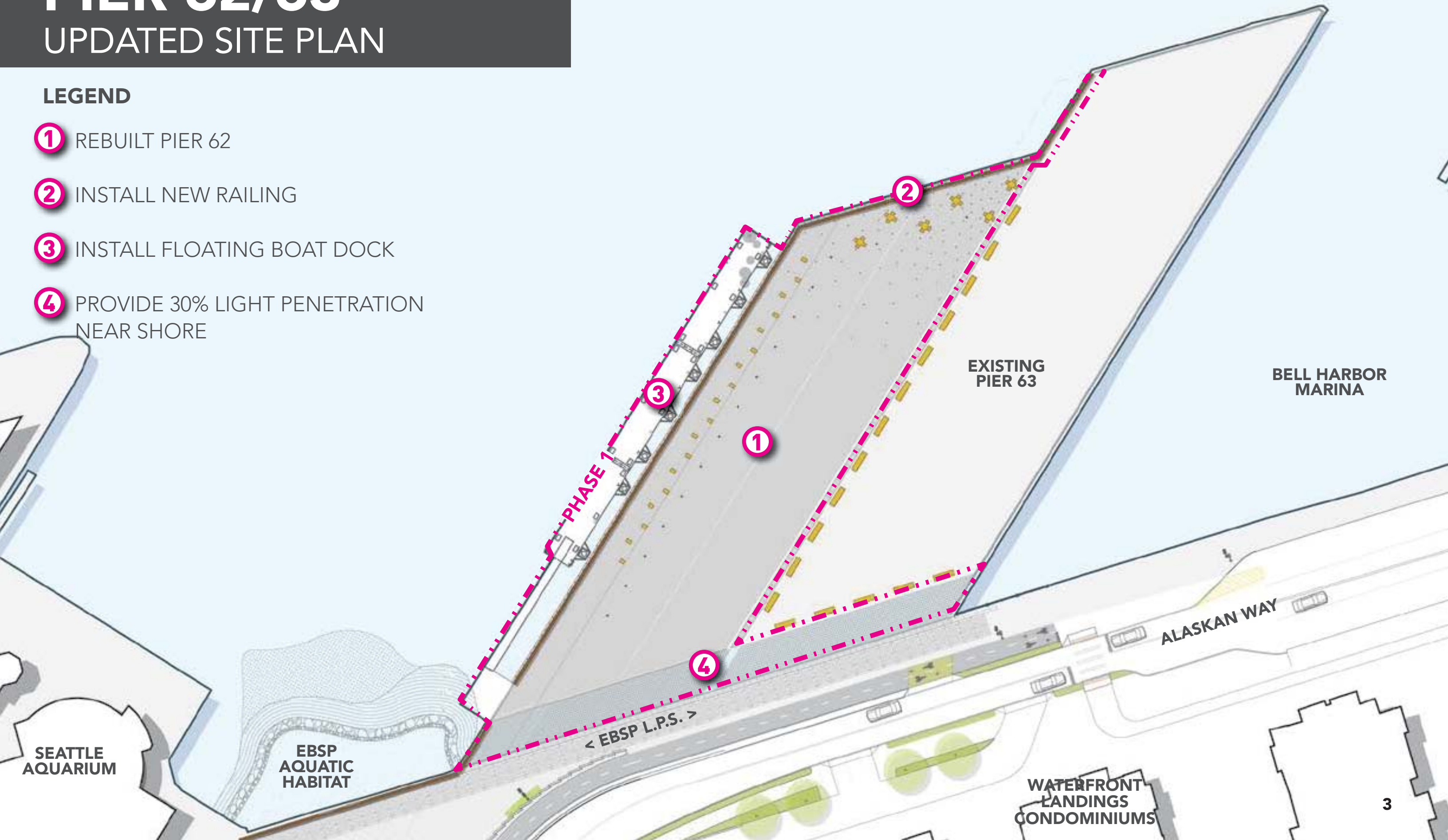

PIER 62/63

PROGRAM: ACTIVITY PIER

① CENTRAL FLEXIBLE FLOOR *63,600 SF*

- PERFORMANCES / CONCERTS
- TICKETED / ACCESS-CONTROLLED EVENTS
- PLAYA SEATTLE
- MOBILE VENDING CARS
- ROLLER SKATING
- STREET HOCKEY
- BEACH VOLLEY BALL
- BEER GARDEN
- WATCHING FIRE WORKS
- SMALL GATHERINGS
- MOVIES

② TEMPORARY CANOPIES *20,000 SF*

- REFRESHMENTS
- EVENTS
- RENTALS (ROLLERSKATES, BOATS, ETC.)
- INFORMATION/SHELTER

③ PUBLIC ART

- ANN HAMILTON INSTALLATION
- BARBARA KRUGER EXISTNG ART

④ VIEWING

- SUNSET
- AQUARIUM
- HABITAT
- BOATS

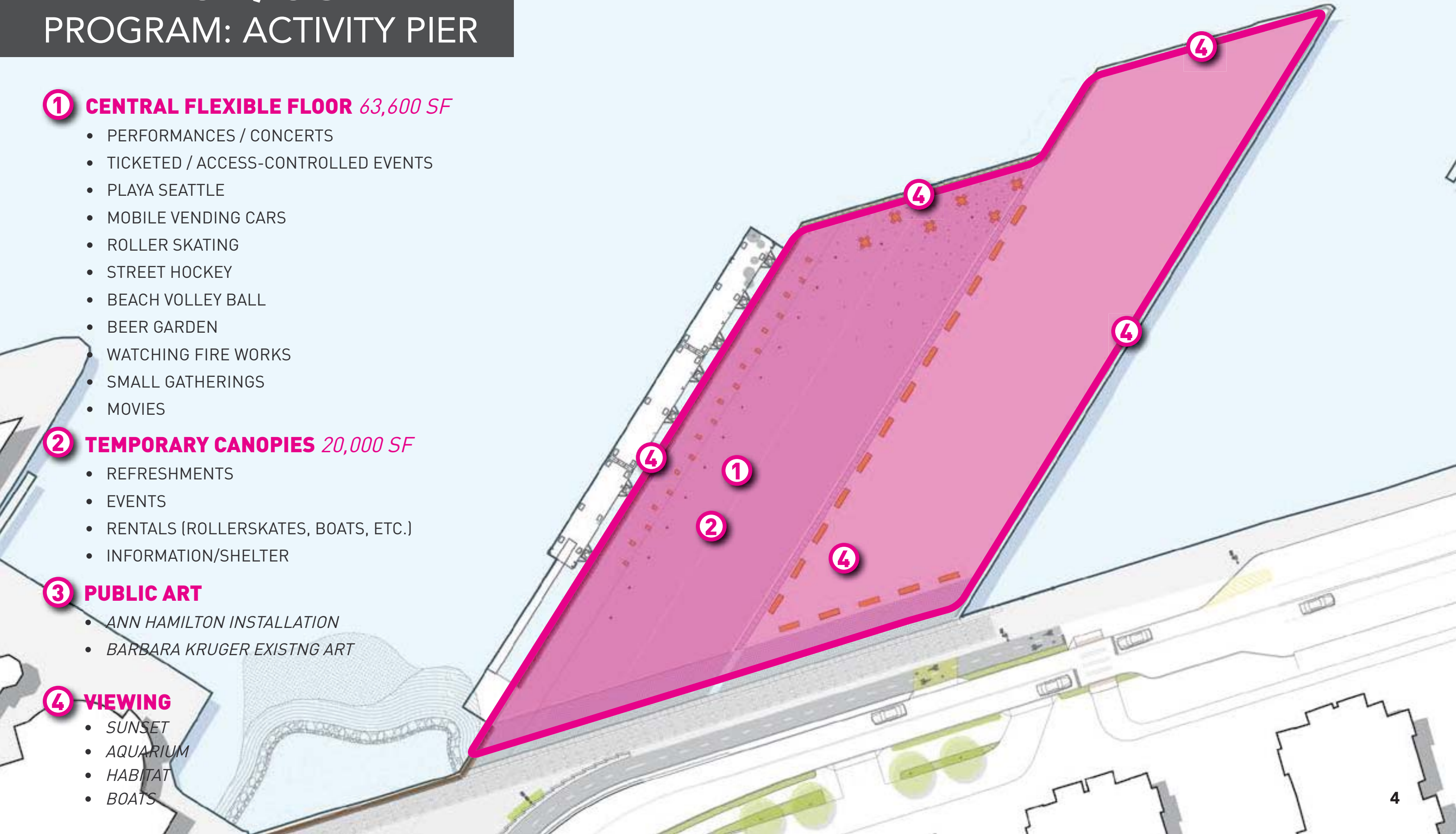

PIER 62/63

PROGRAM: ACTIVITY PIER



SOCCER



ROLLER HOCKEY



WATCHING BOATS



WATCHING FIREWORKS



WATCHING SUNSET



BASKETBALL



TENTS



MOBILE VENDING CARTS



CONCERTS

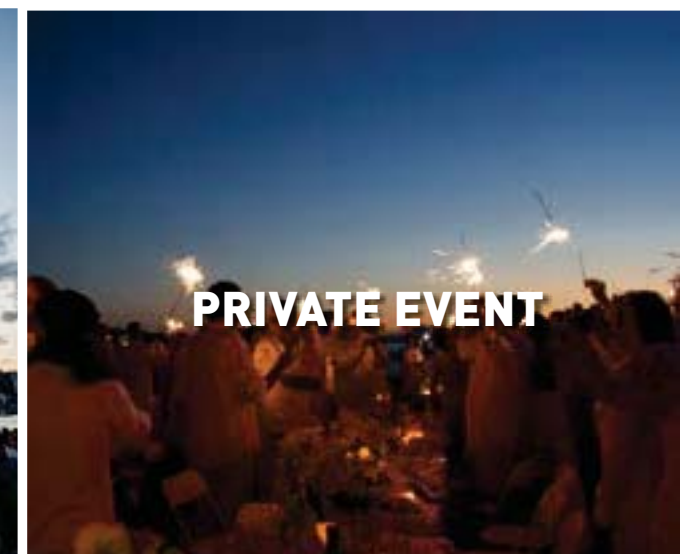

PRIVATE EVENT

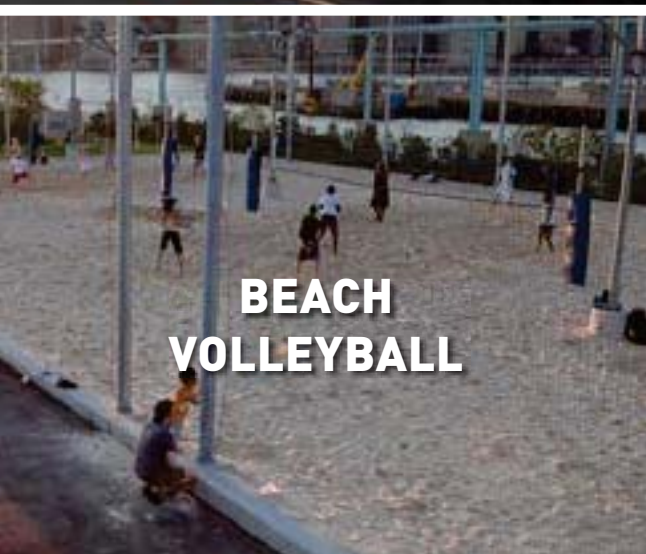

BEACH VOLLEYBALL



ROLLER SKATING



SITTING



BEACH LOUNGING



ENJOYING THE EDGE

PIER 62/63

PROGRAM: WATER'S EDGE

① BOAT LAUNCH 5,000 SF

- BOAT LAUNCH
- KAYAK LAUNCH

② OPEN WATER EDGE 16,000 SF

- DOCKING BOATS
- MOORING ACTIVITY BARGE
- MARITIME USES (SEAFOOD SALES)
- FISHING

③ HABITAT OBSERVATION 5,000 SF

- HABITAT BENCH
- SEAWALL FACE
- OBSERVATION BOATS

④ PUBLIC ART 5,000 SF

- STEPHEN VITIELLO SOUND INSTALLATION
- LAURA HADDAD SEAWALL PANEL INSTALLATION

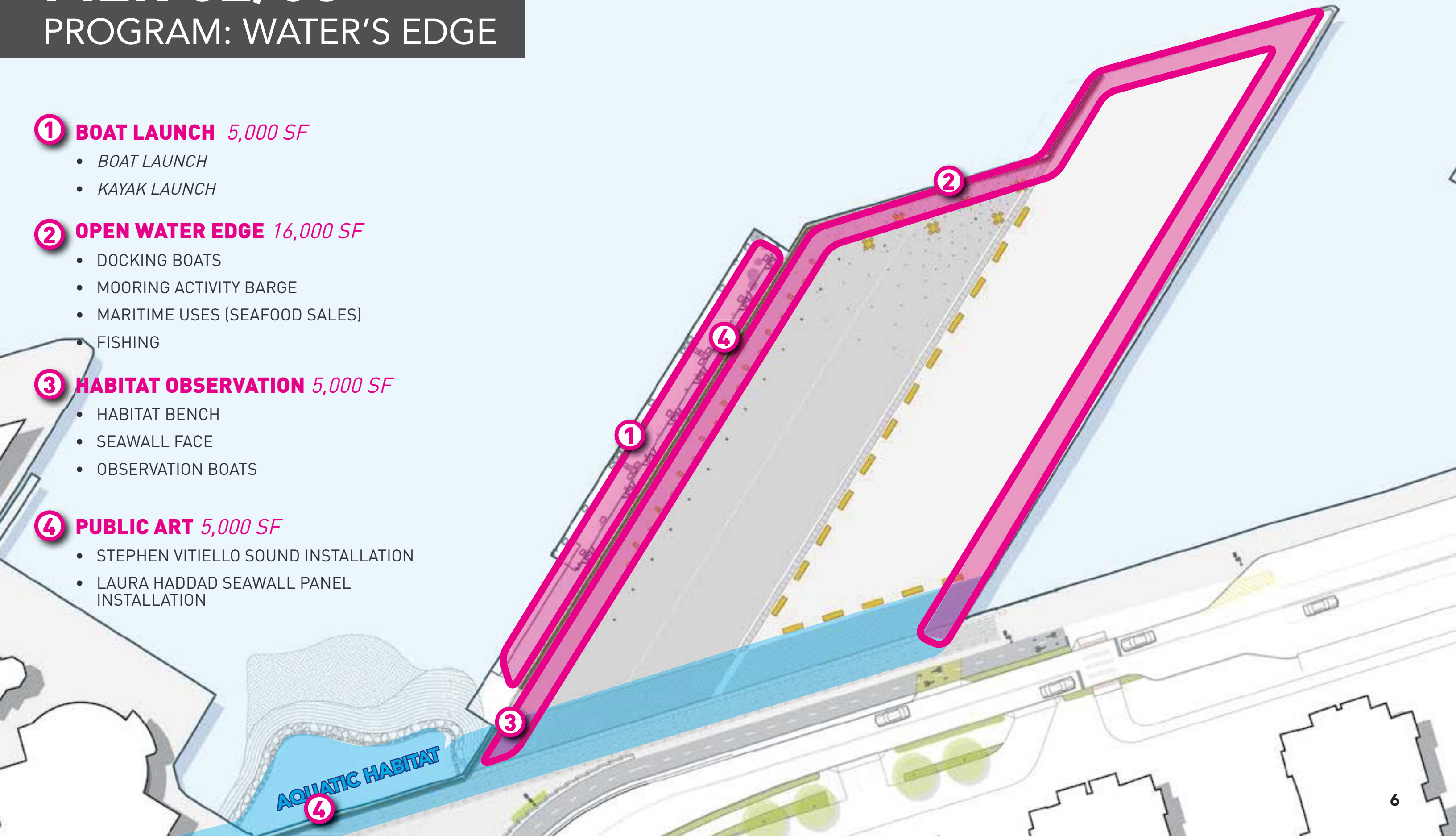

PIER 62/63

PROGRAM: WATER'S EDGE



FARM BOAT MARKET



FLEET WEEK



SEAFOOD SALES



KAYAKING



SALISH CANOES



FISHING



HABITAT OBSERVATION



AQUATIC HABITAT



BARGE EVENTS



BOAT LAUNCH

14 Land Bank Sites

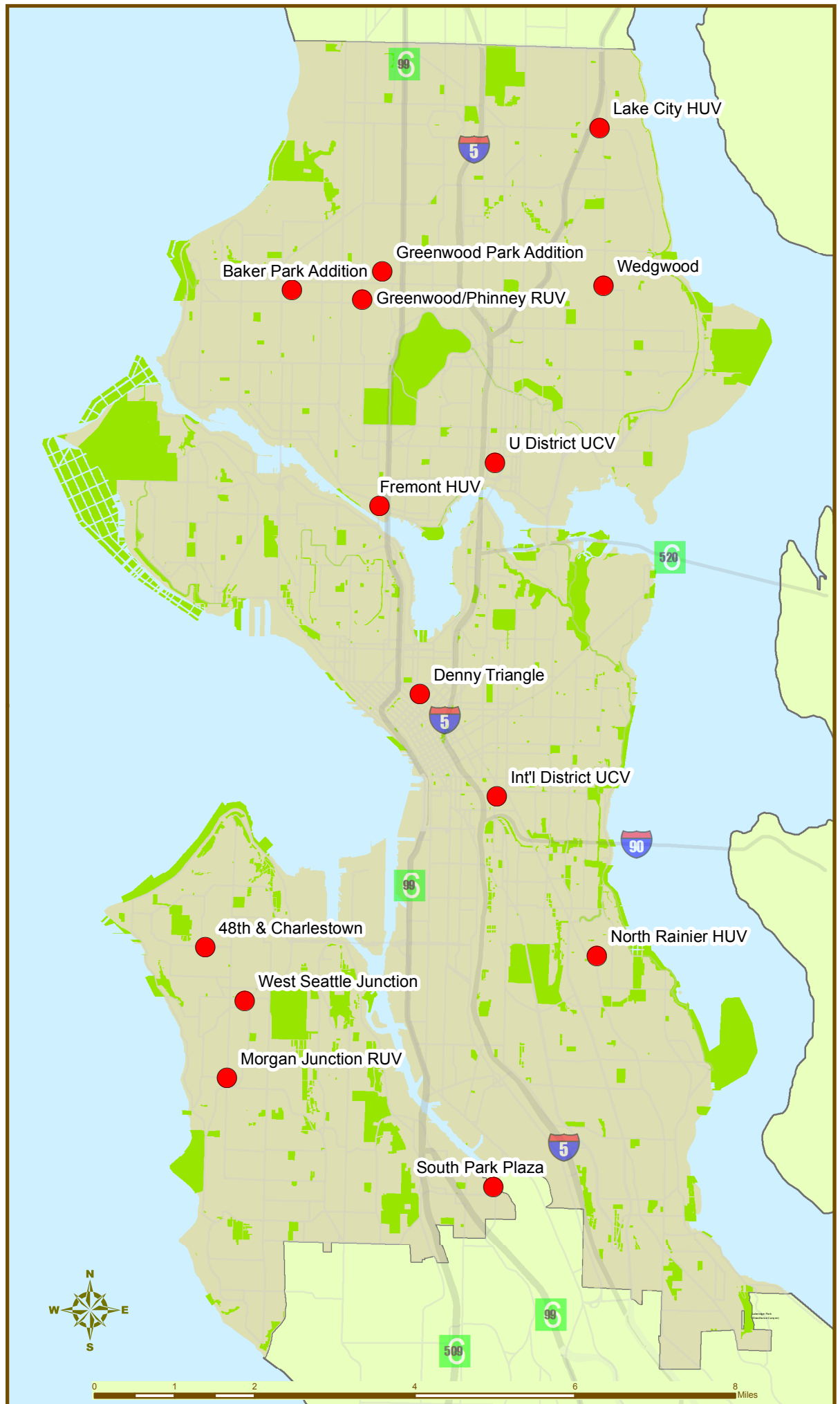

Legend

- Land Bank Sites
- Park Boundary



©2014, CITY OF SEATTLE
All rights reserved.

No warranties of any sort, including accuracy, fitness or merchantability accompany this product.

Map Date: 4/7/2014

PIER 62/63

MATERIALS

LEGEND

- ① CONCRETE DECK
- ② EXISTING WOOD DECK
- ③ METAL GRATING
- ④ FLOATING DOCK + GANGWAY



SEATTLE
AQUARIUM

EBSP
AQUATIC
HABITAT

< Ebsp L.P.S. >

EXISTING
PIER 63

BELL HARBOR
MARINA

ALASKAN WAY

WATERFRONT
LANDINGS
CONDOMINIUMS

PIER 62/63

CONCRETE DECK



PIER 62/63

GRATING AS LIGHT PENETRATING SURFACE

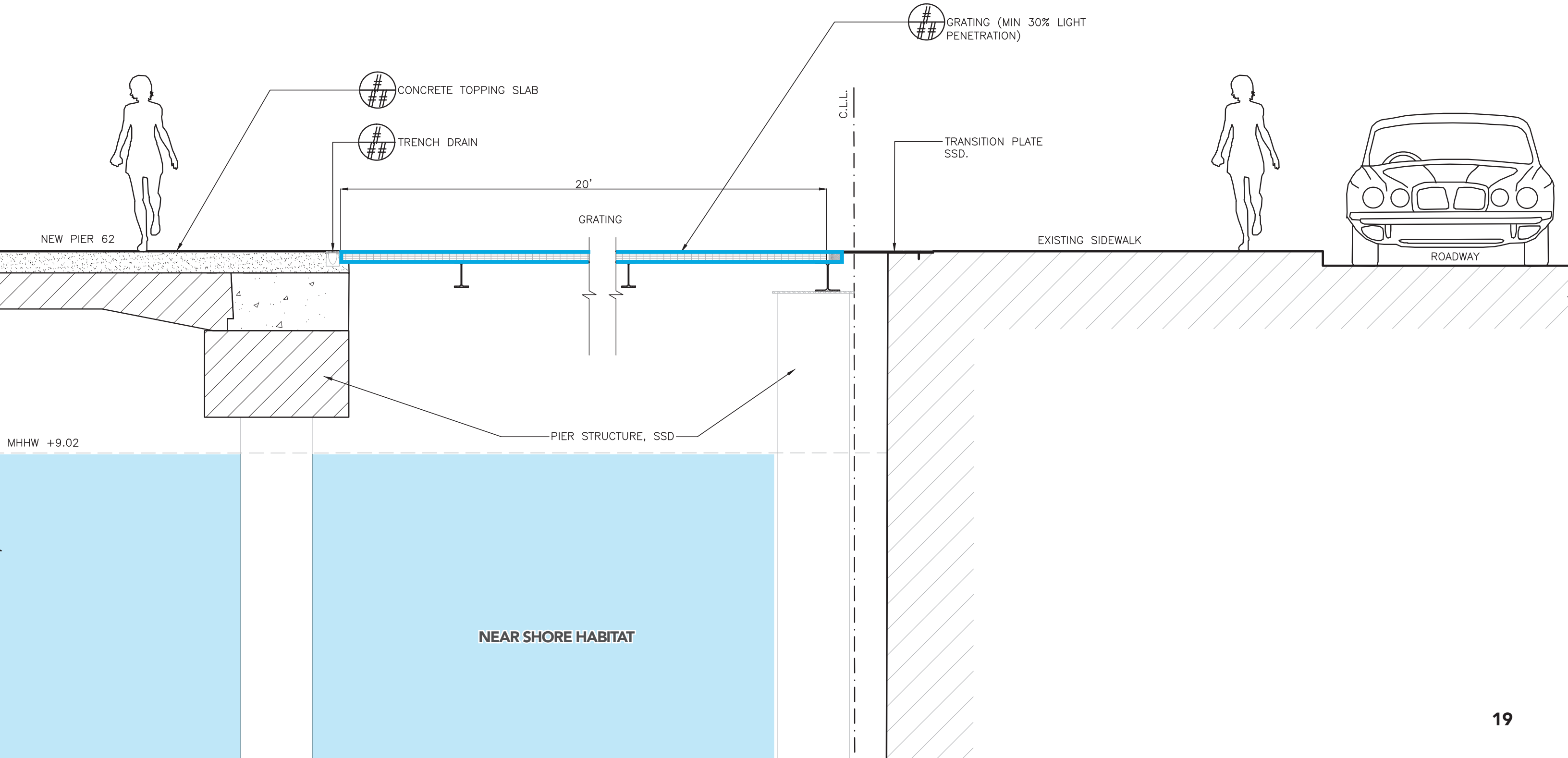

PIER 62/63

GRATING AS LIGHT PENETRATING SURFACE

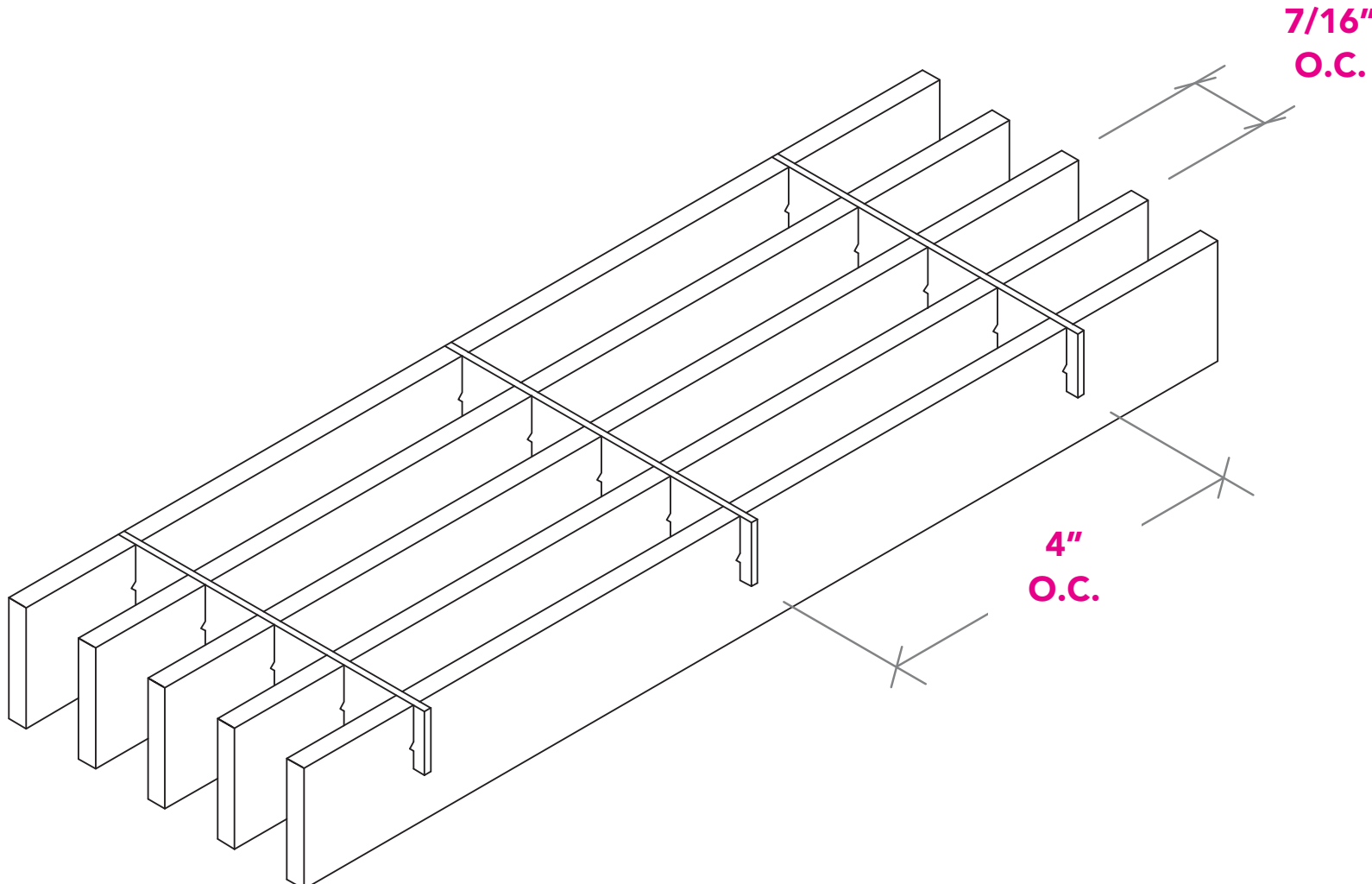

NYC, SOUTH
STREET
SEAPORT

PIER 62/63

PUBLIC ART PROGRAM

EXISTING: LAURA HADDAD



PIER 62/63

OFF-THE-SHELF GANGWAY AND FLOATING DOCK



PIER 62/63

RAILINGS

LEGEND

- ① WATERFRONT RAILING
- ② EXISTING PIER 63 RAILING
- ③ GATE TO DOCK

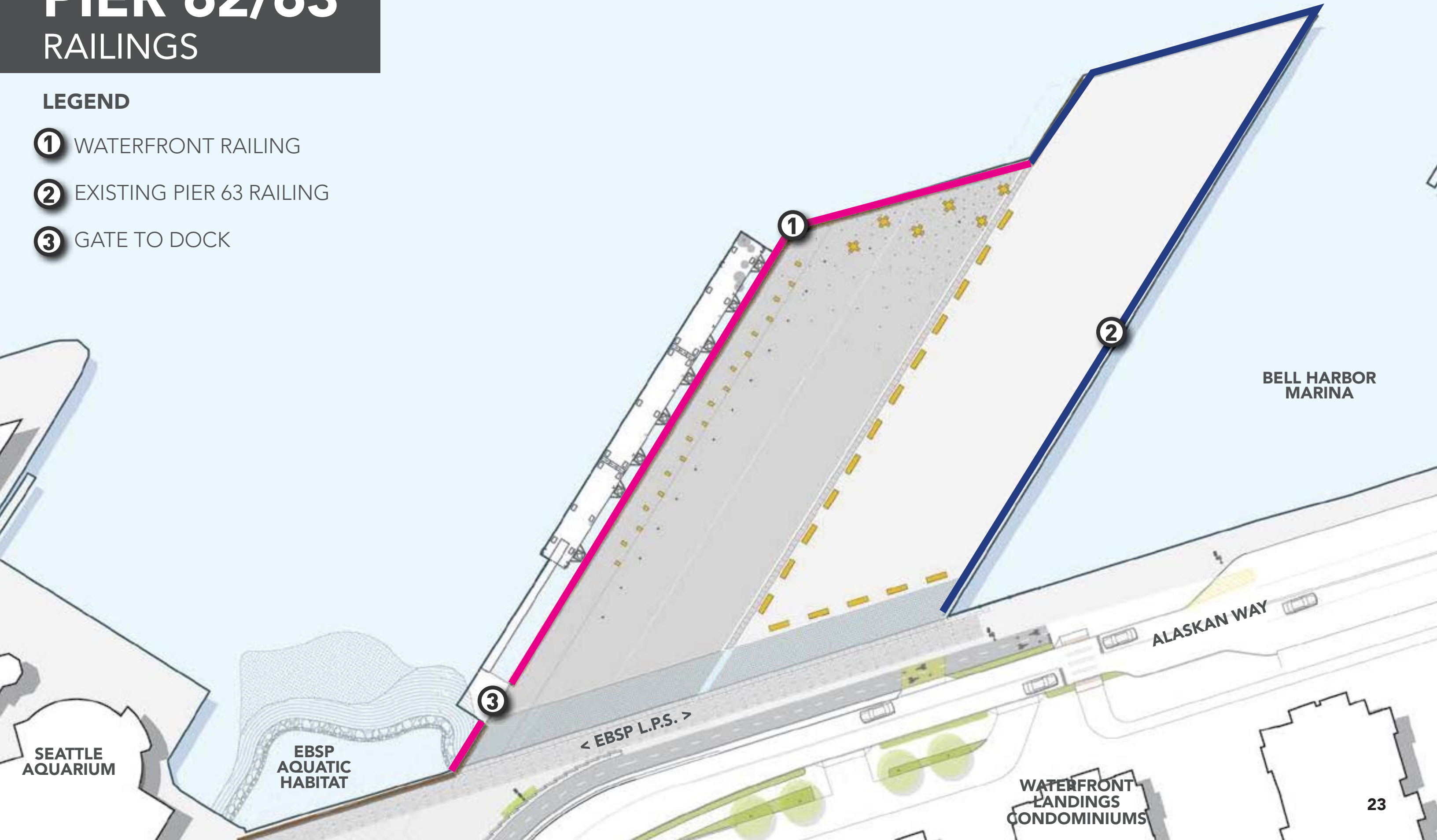

SEATTLE
AQUARIUM

EBSP
AQUATIC
HABITAT

< EBSP L.P.S. >

ALASKAN WAY

BELL HARBOR
MARINA

WATERFRONT
LANDINGS
CONDOMINIUMS

PIER 62/63

PIER 62 NEW RAILINGS



PIER 62/63
FISHERMAN'S NET



PIER 62/63

EKKI WOOD TOP



PIER 62/63

LIGHTING

- 1 PIER EDGE LIGHTING
- 2 IN-GRADE LIGHTING
- 3 FLOATING DOCK LIGHTING



PIER 62/63

PIER EDGE LIGHTING

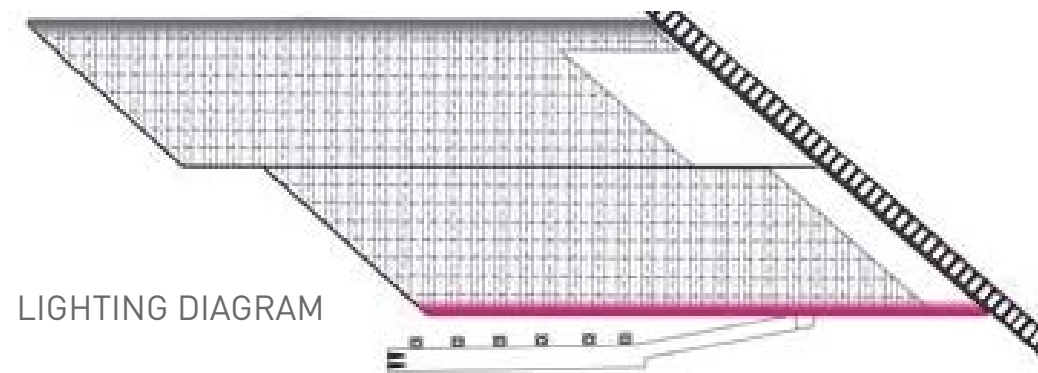

Proposed edge lighting will be utilized at the South edge of Pier 62 and the North edge of Pier 63 (in the future). This approach reinforces wayfinding paths while revealing the length and depth of the Pier structure. In addition, the edge lighting approach enhances nighttime safety and security on these structures. The Western edge of the Pier is purposefully left non-illuminated allowing occupants to take in the unobstructed nighttime view of the Sound.

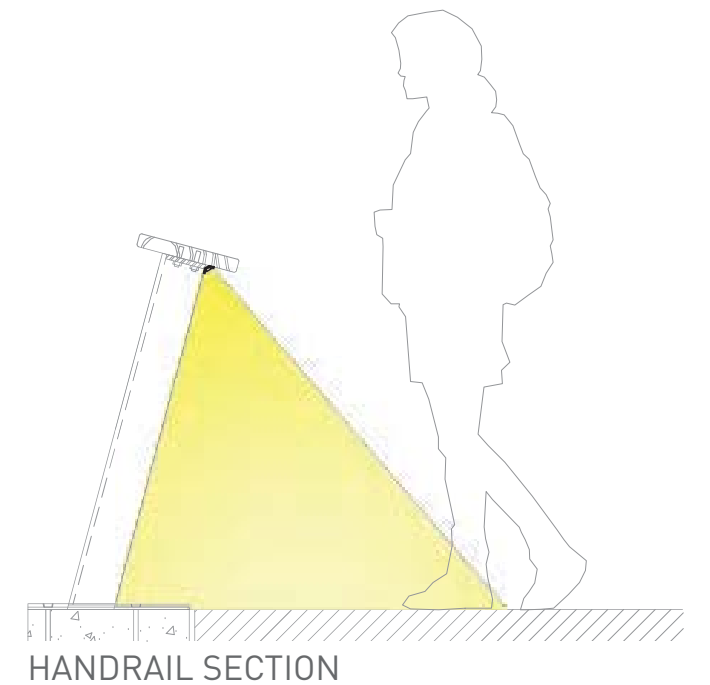

PIER 62/63

LIGHTING



PIER 62/63

LIGHTING



PIER 62/63

LIGHTING



PIER 62/63

CAPACITY DIAGRAM

WEEKDAY: 2,000 PEOPLE

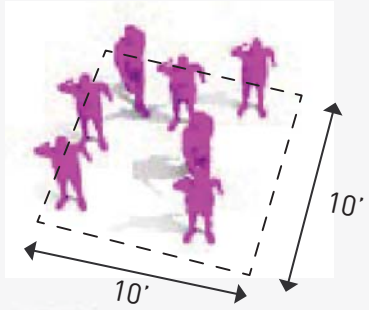

1 PERSON STANDING
/ 15sqfT

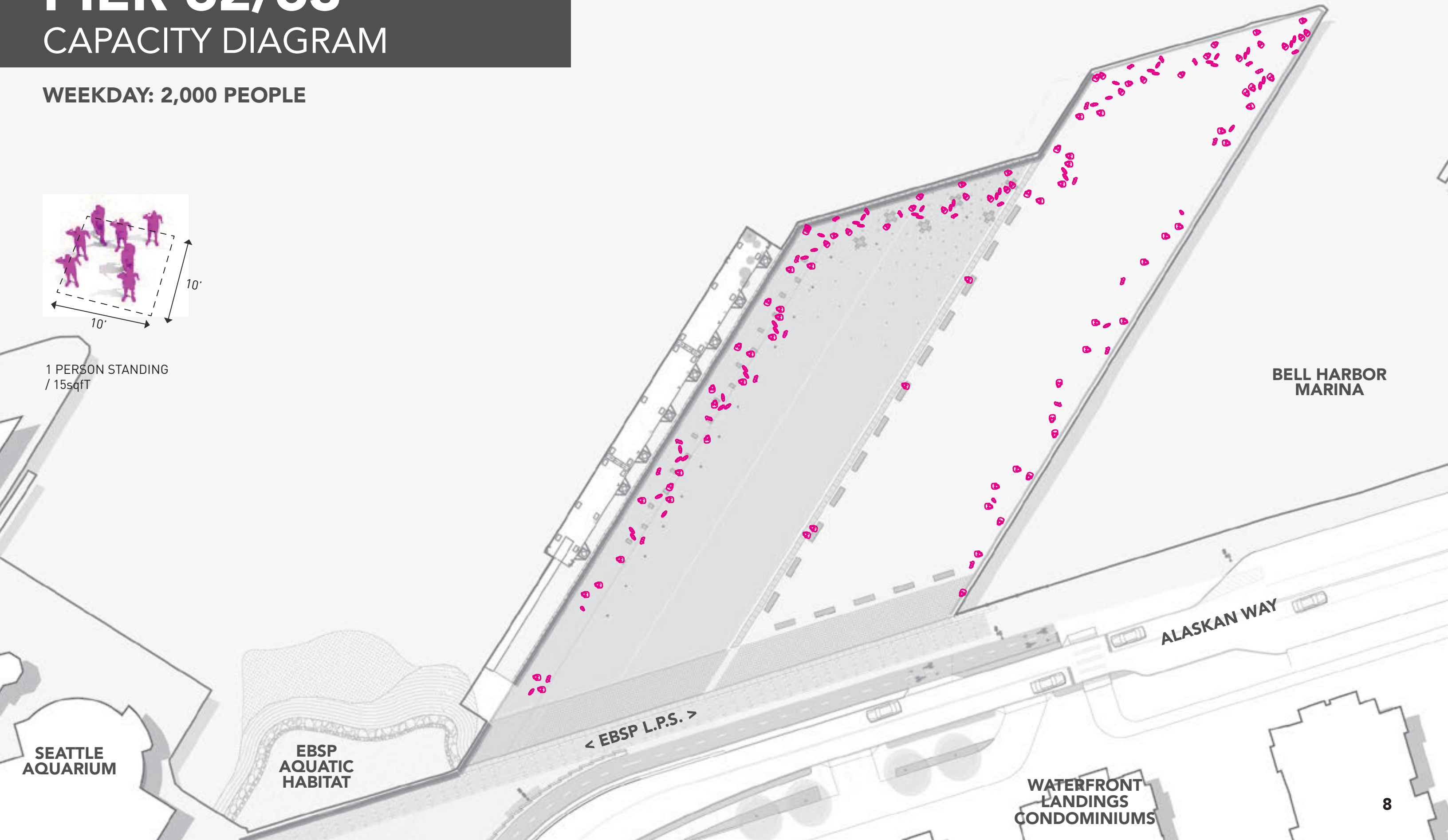

BELL HARBOR
MARINA

ALASKAN WAY

< Ebsp L.P.S. >

SEATTLE
AQUARIUM

Ebsp
AQUATIC
HABITAT

WATERFRONT
LANDINGS
CONDOMINIUMS

PIER 62/63

CAPACITY DIAGRAM

INFORMAL GATHERING: 3,000 PEOPLE

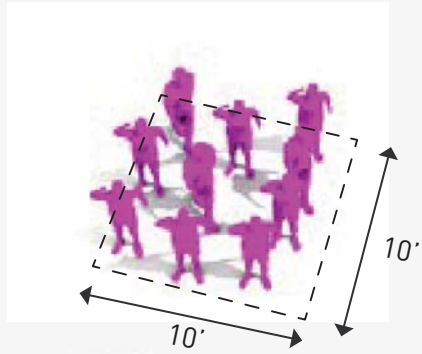

1 PERSON STANDING
/ 10sqft

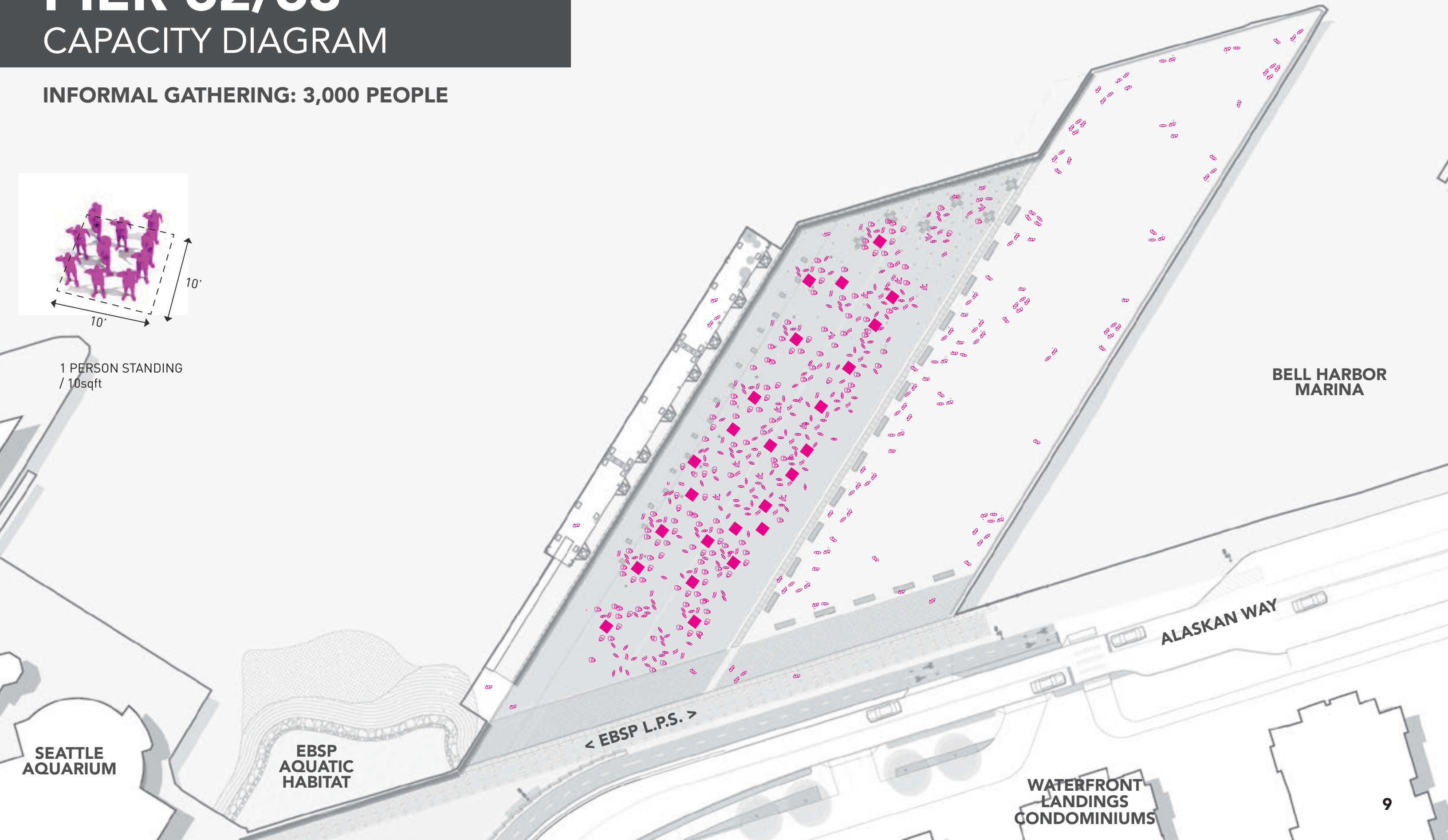

BELL HARBOR
MARINA

ALASKAN WAY

< EBSP L.P.S. >

SEATTLE
AQUARIUM

EBSP
AQUATIC
HABITAT

WATERFRONT
LANDINGS
CONDOMINIUMS

PIER 62/63

CAPACITY DIAGRAM

CONCERT: 6,000 PEOPLE

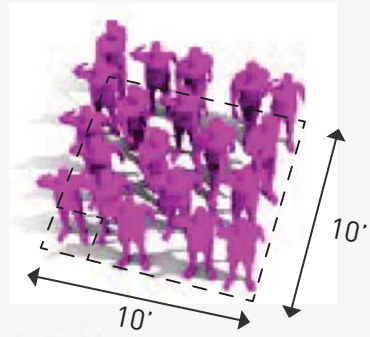

1 PERSON STANDING
/ 5sqft

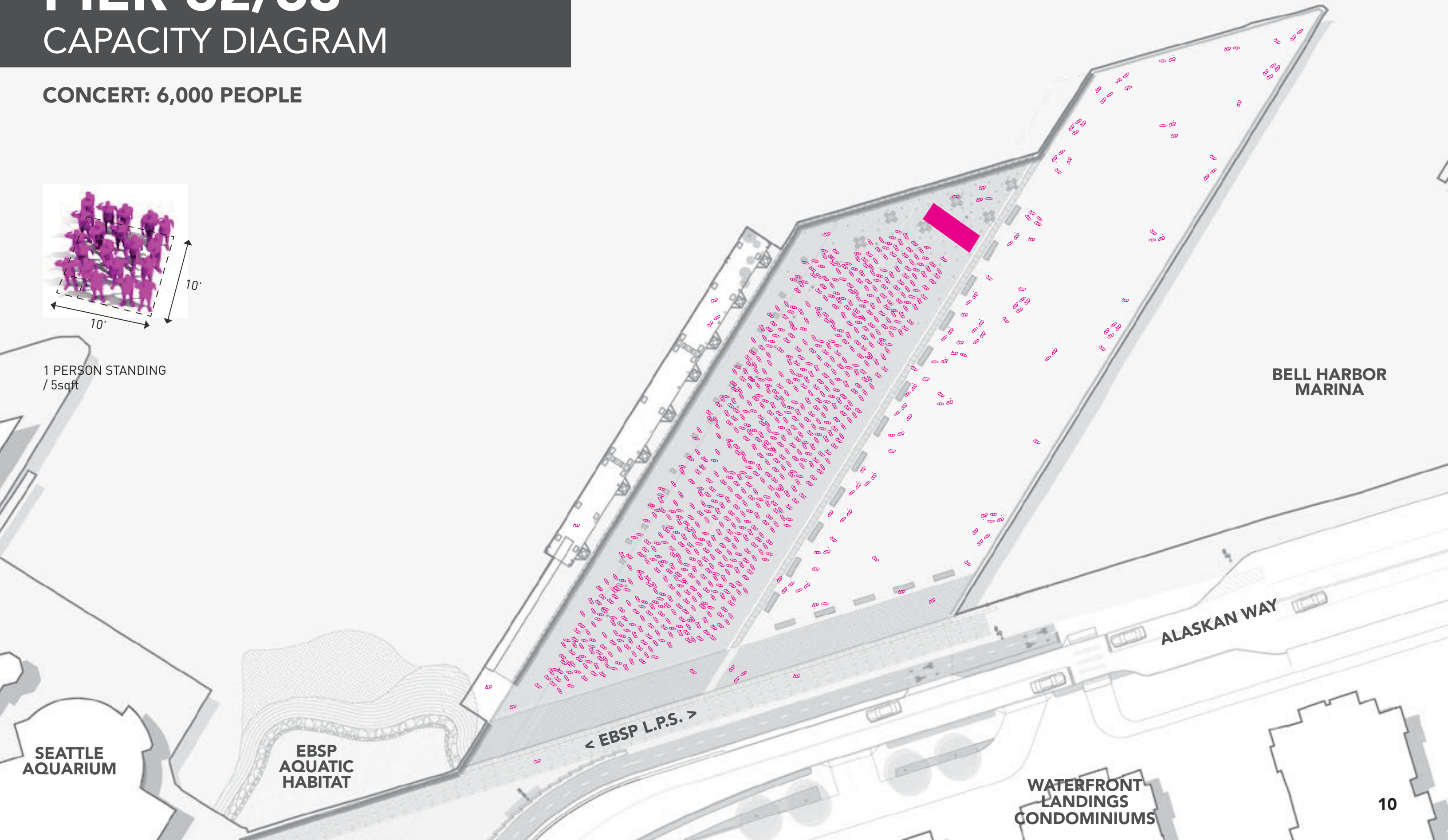

BELL HARBOR
MARINA

ALASKAN WAY

< Ebsp L.P.S. >

SEATTLE
AQUARIUM

Ebsp
AQUATIC
HABITAT

WATERFRONT
LANDINGS
CONDOMINIUMS

PIER 62/63

CAPACITY DIAGRAM

CONCERT: 500, 1,000, AND 1,500 PEOPLE EVENTS SEATED

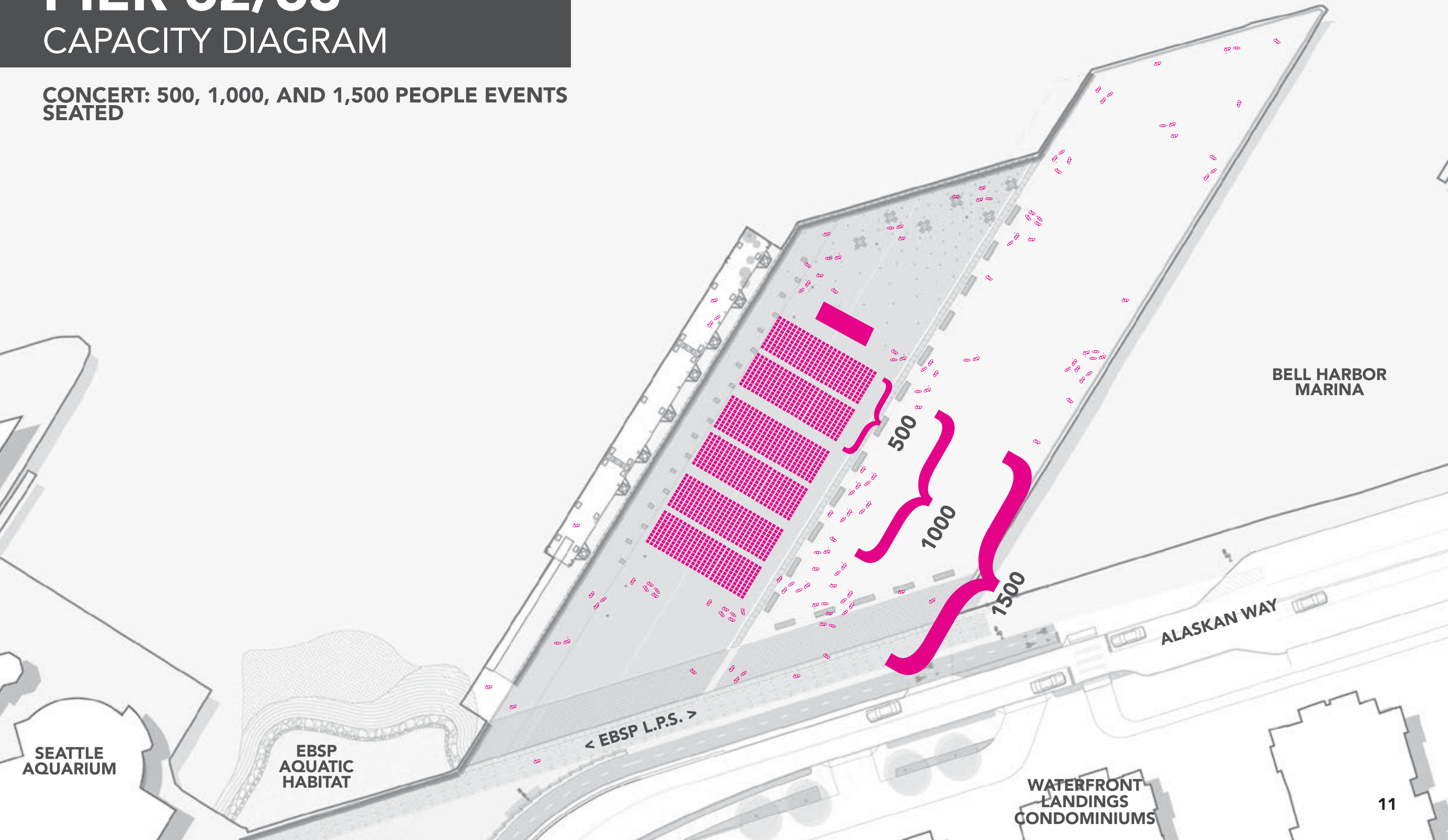

BELL HARBOR MARINA

ALASKAN WAY

< EBSP L.P.S. >

SEATTLE AQUARIUM

EBSP AQUATIC HABITAT

WATERFRONT LANDINGS CONDOMINIUMS

PIER 62/63

CAPACITY DIAGRAM

CONCERT: 500, 1,000, AND 1,500 PEOPLE EVENTS SEATED

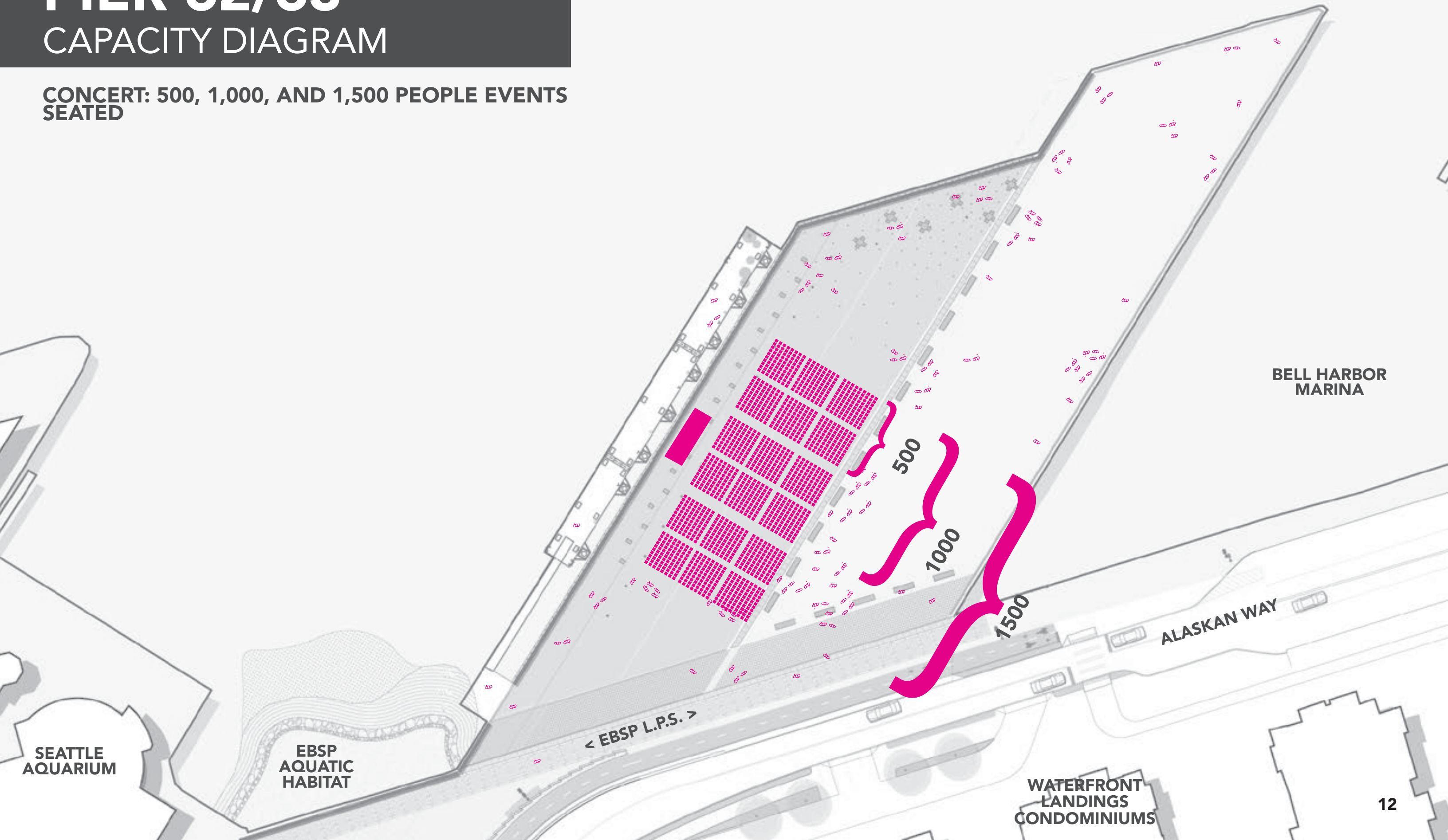

BELL HARBOR MARINA

SEATTLE AQUARIUM

EBSP AQUATIC HABITAT

< EBSP L.P.S. >

WATERFRONT LANDINGS CONDOMINIUMS

ALASKAN WAY

PIER 62/63

CAPACITY DIAGRAM

CONCERT: 6,000 PEOPLE

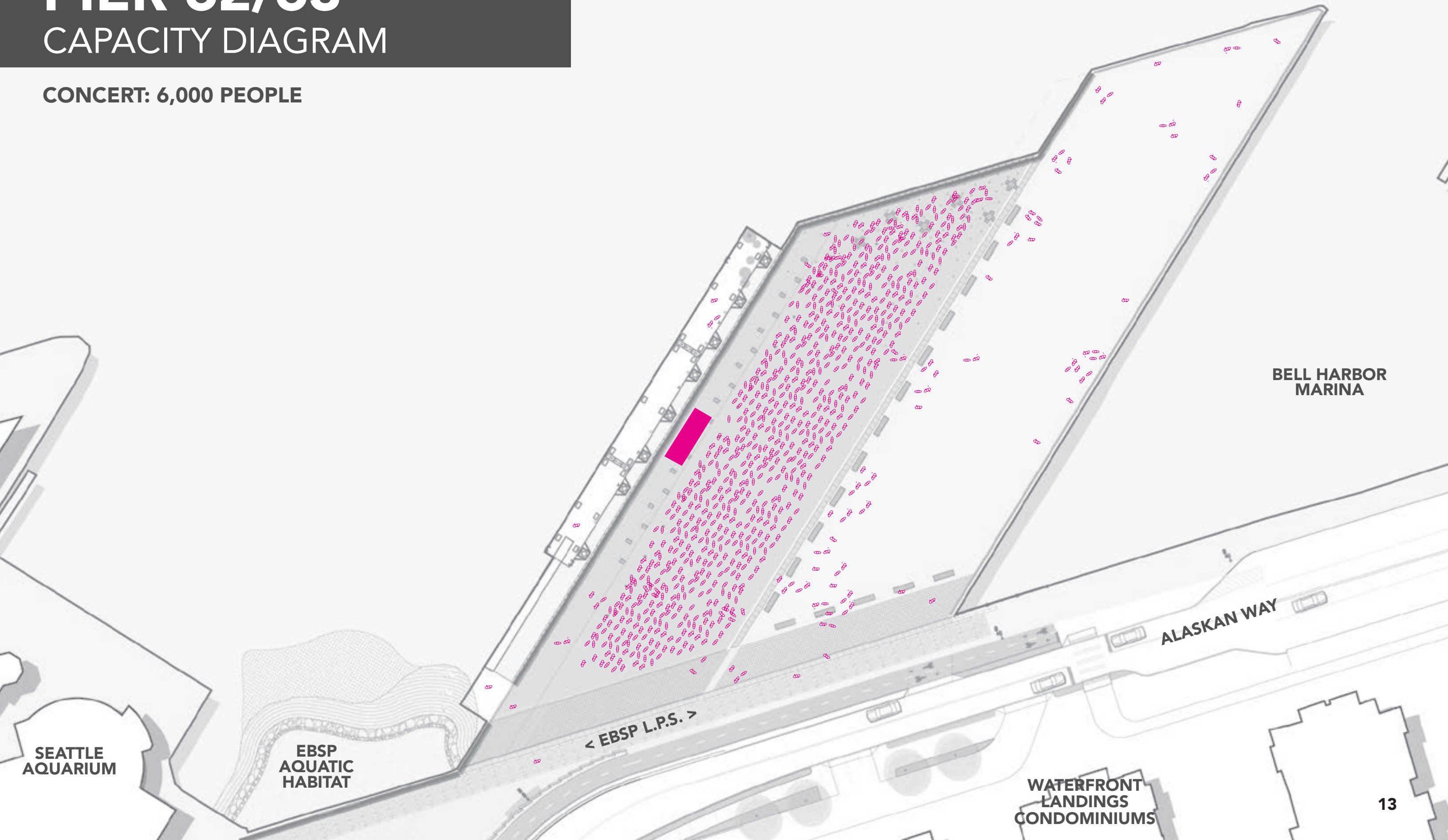

PIER 62/63

ACTIVE PROGRAM OPTIONS

MINI SOCCER, BASKETBALL, VOLLEYBALL, TABLE TENNIS

① SOCCER PITCH

- 80 X 120
- 50 X 100

② BASKETBALL COURT

- 50 X 95

③ VOLLEYBALL COURT

- 60 X 30

④ TABLE TENNIS

- 9 X 5

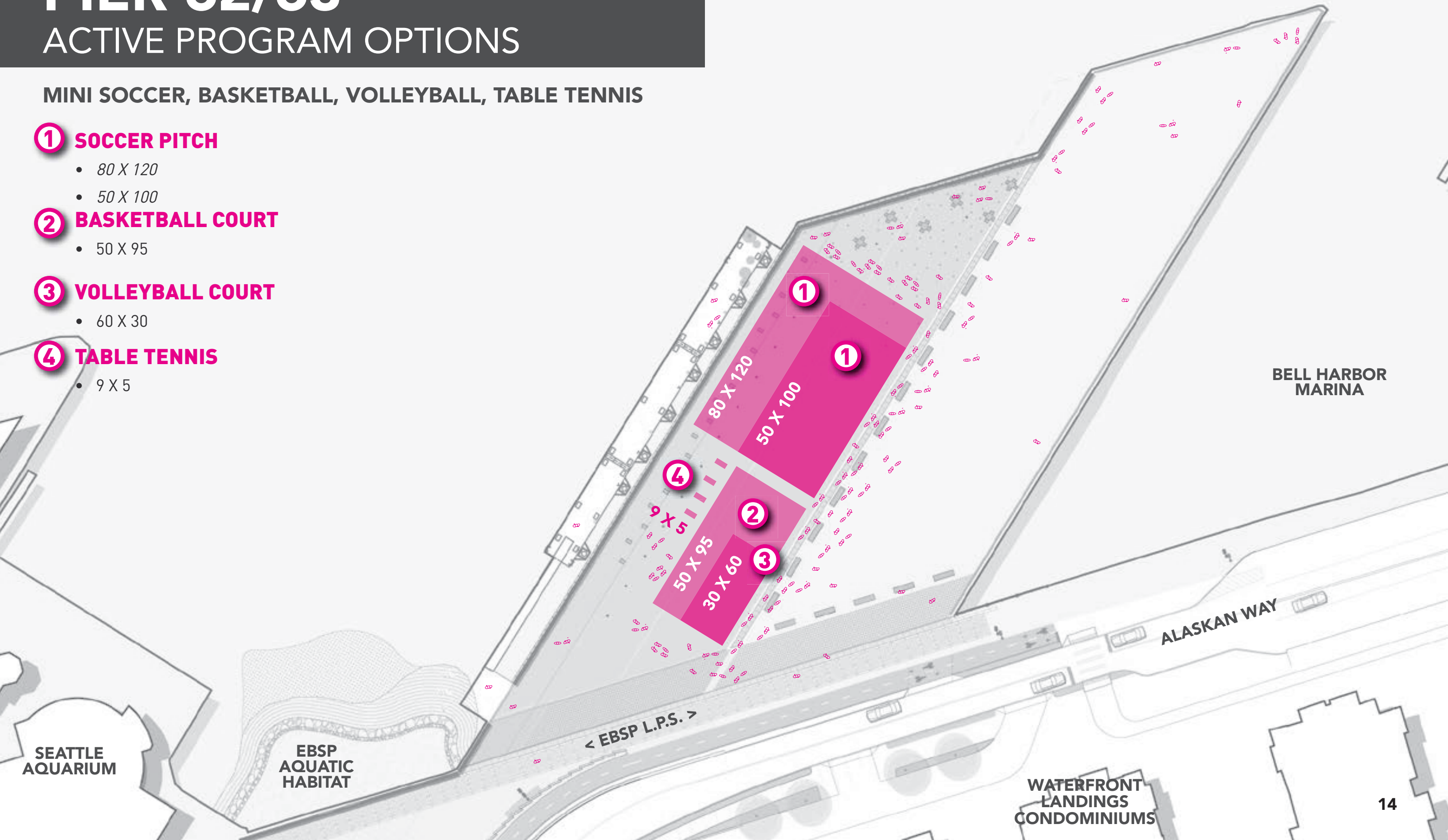

BELL HARBOR MARINA

ALASKAN WAY

SEATTLE AQUARIUM

Ebsp AQUATIC HABITAT

WATERFRONT LANDINGS CONDOMINIUMS

PIER 62/63

UPDATED SITE PLAN

LEGEND

- ① REBUILT PIER 62
- ② NEW RAILING
- ③ FLOATING BOAT DOCK + GANGWAY
- ④ STEEL GRATE WITH 30% LIGHT PENETRATION AT NEAR SHORE

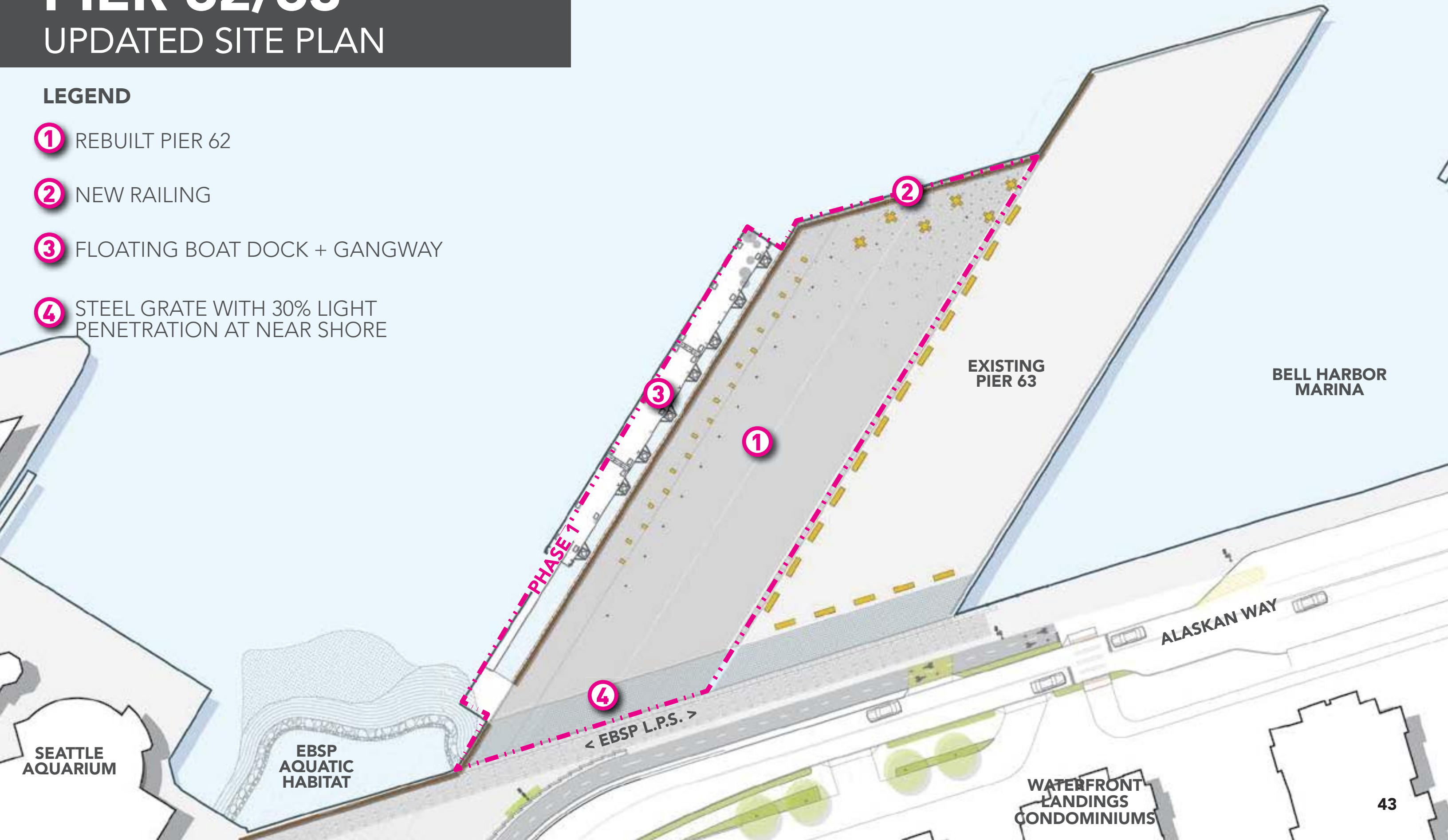

SEATTLE
AQUARIUM

EBSP
AQUATIC
HABITAT

EXISTING
PIER 63

BELL HARBOR
MARINA

ALASKAN WAY

WATERFRONT
LANDINGS
CONDOMINIUMS

END